

# CONFERENCE PRELIMINARY PROGRAMME

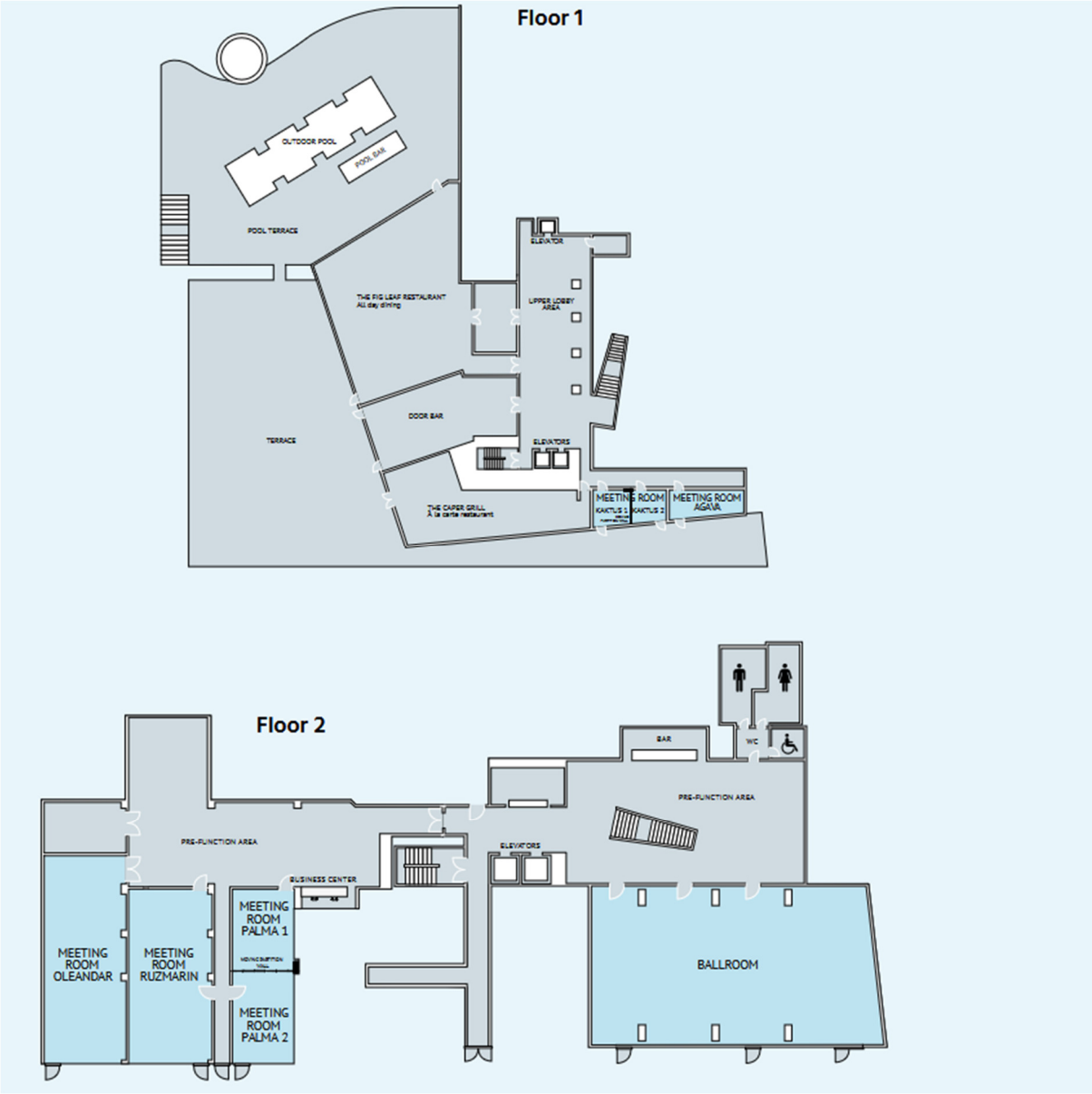

WEDNESDAY 19/3/2025				
08:00-09:00	Registration			
	Ballroom			
09:00 - 09:15	OPENING CEREMONY			
09:15- 09:30				
09:30- 09:45				
09:45- 10:00				
10:00 - 10:15				
10:15- 10:30	Coffee break			
10:30- 10:45				
10:45- 11:00				
	Ballroom	Oleandar	Ruzmarin	Palma
	Session: EXPERIMENTAL TECHNIQUES FOR CHARACTERIZATION OF MATERIALS AND STRUCTURES	Session: LESSONS LEARNT FROM EARTHQUAKE DISASTERS	Session: SEISMIC PERFORMANCE OF STRUCTURES	ROUND TABLE ON POST-EARTHQUAKE RETROFITTING EXPERIENCES AND THE IMPERATIVE OF SEISMIC SAFETY CLASSIFICATION FOR BUILDINGS IN CROATIA (in Croatian)
11:00 - 11:15	33# Gerard O'Reilly, Igor Lanese, Elisa Rizzo Parisi, Filippo Dacarro, Volkan Ozsarac, Davit Shahnazaryan, Roberto Nascimbene, Gian Michele Calvi: ADVANCING SEISMIC DESIGN AND ASSESSMENT THROUGH EXPERIMENTAL TESTING: INSIGHTS FROM THE ERIES PROJECT	13# Asma Yahiaoui, Oguz Koz, Oguz C Celik: COMPUTED BI-DIRECTIONAL COMBINATION COEFFICIENTS FOR STRUCTURES USING THE FEB. 6TH, 2023 KAHRAMANMARAS EARTHQUAKES GROUND MOTION DATA	103# Jui-Liang Lin: AUGMENTED MODAL DIMENSIONS FOR SEISMIC EVALUATION OF BUILDINGS	
11:15- 11:30	56# Nives Meštrović, Ivica Guljaš: TESTING OF THE SEISMIC BEHAVIOUR OF A TRADITIONAL JOINT IN A WOODEN ROOF STRUCTURE	14# Oguz Koz, Sinem Guntepe, Oguz C Celik: ANALYSIS OF SGM DATA CHARACTERISTICS FOR BETTER EXPLANATION OF BUILDING DAMAGE DURING THE FEB.6TH, 2023 KAHRAMANMARAS, TURKEY EARTHQUAKES	23# Alush Shala, Jelena Bleiziffer: RESEARCH IMPERATIVES FOR ENHANCING THE ANALYSIS AND SEISMIC PERFORMANCE OF JOINTS IN VERTICAL BUILDING EXTENSIONS	
11:30- 11:45	77# Giovanni Muciaccia, Laura Corti: PUSH-OUT TESTS ON TIMBER-STEEL HYBRID JOINT WITH SCREWS CONNECTIONS. NUMERICAL AND EXPERIMENTAL INVESTIGATIONS	97# Božidar Stojadinović, Marko Marinković, Dejan Marinković, Filip Đorđević, Marija Ivanović, Miloš Kovačević, Mladen Nikolić, Nevena Simić, Zoran Babović, Zoran Pucanović, Zoran Stojadinović, Đorđe Nedeljković: RAPID EARTHQUAKE LOSS ASSESSMENT FRAMEWORK: RELAR PROJECT AND ITS APPLICATION ON THE DATA SET FROM THE KRALJEVO (SERBIA) EARTHQUAKE IN 2010	111# Ana Nanevska, Violeta Mircevska: NUMERICAL EXPERIMENT FOR SHEAR KEY JOINT BEHAVIOR SIMULATION IN ARCH DAMS: PART 1 – INVESTIGATING THE INFLUENCE OF THE KEY SHAPE AND ANGLE	
11:45- 12:00	52# Ilir Canaj, Jelena Ristic, Elena Dumova-Jovanoska, Danilo Ristic: PROTECTION OF SENSITIVE INFILL IN FRAME BUILDINGS USING SB-UPGRADED ISOLATION SYSTEM: SEISMIC TESTS OF MODEL	110# Ante Pilipović, Karlo Jandrić: FIELD OBSERVATIONS OF BUILDINGS AND INFRASTRUCTURE BEHAVIOUR DURING 2024 FLOODS AND ROCKFALL IN BOSNIA AND HERZEGOVINA	112# Violeta Mircevska, Ana Nanevska: NUMERICAL EXPERIMENT FOR SHEAR KEY JOINT BEHAVIOR SIMULATION IN ARCH DAMS: PART 2 – INVESTIGATING THE INFLUENCE OF THE ARCH THICKNESS AND APPLIED FORCE	
12:00 - 12:15	44# Suzana Ereiz, Ivan Duvnjak, Janko Koščak, Marko Bartolac, Domagoj Damjanović, Marina Frančić Smrkic: INTEGRATION OF OMA AND FEMU FOR ESTIMATION MODULUS OF ELASTICITY IN MASONRY STRUCTURES	130# Filip Đorđević, Marko Radišić, Svetlana Brzev, Marko Marinković: SUZI-SAAE EARTHQUAKE IMAGE DATABASE: A FRAMEWORK FOR TAGGING EARTHQUAKE-INDUCED DAMAGE	21# Elena Stokuca, Golubka Necevska-Cvetanovska, Milos Stokuca: DYNAMIC EFFECTS IN TALL STEEL STRUCTURES WITH DIFFERENT PURPOSES	
	Ballroom			
12:15- 12:30	Keynote Lecture			
12:30- 12:45	Paulo B. Lourenço			
12:45- 13:00	MASONRY ENCLOSURES: DAMAGE, APPLICATIONS, LESSONS LEARNED FROM TESTING AND NEW SOLUTIONS			
13:00- 14:00	LUNCH			
14:00 - 14:15	Marketing: SPEGRA			
14:15- 14:30	Keynote Lecture			
14:30- 14:45	Miha Tomažević			
14:45- 15:00	TESTING FOR THE ASSESSMENT OF EARTHQUAKE RESISTANCE OF HERITAGE MASONRY BUILDINGS: NONDESTRUCTIVE VERSUS DESTRUCTIVE, LABORATORY VERSUS IN-SITU TESTING			
15:00 - 15:15	TECHNICAL VISIT: Diocletian's Palace			
15:15- 15:30	Arrival at Diocletian's Palace			
15:30- 15:45	Guided Tour: Diocletian's Palace			
15:45- 16:00	Presentation on the City of Split - City Center			
16:00- 16:15				
16:15- 16:30				
16:30- 16:45				
16:45- 17:00				
17:00 - 17:15				
17:15- 17:30				
17:30- 17:45				
17:45- 18:00				
18:00 - 18:15				
18:15- 18:30				
18:30- 18:45				
18:45- 19:00				
19:00 - 19:15				
19:15- 19:30				
19:30- 19:45				
19:45- 20:00				
20:00- 00:00				

THURSDAY 20/3/2025				
Ballroom				
09:00 - 09:15	Keynote Lecture Serena Cattari			
09:15 - 09:30	MODELLING AND ANALYSES FOR THE SEISMIC ASSESSMENT OF EXISTING URM BUILDINGS: RESEARCH CHALLENGES AND ENGINEERING-PRACTICE IMPLICATIONS			
09:30 - 09:45	Keynote Lecture Helen Crowley			
09:45 - 10:00	WHY SEISMIC HAZARD MODELLING HAS BECOME A RISKY BUSINESS			
10:00 - 10:15				
10:15 - 10:30				
10:30 - 10:45	Coffee break			
10:45 - 11:00				
	Ballroom	Oleandar	Ruzmarin	Palma
	<b>RISK UNCERTAINTY BRAWL</b> Co-chairs: professors Paolo Bazzurro, Vitor Silva and Dimitrios Vamvatsikos	<b>Session: SEISMIC PERFORMANCE OF STRUCTURES</b>	<b>Session: HISTORICAL STRUCTURES</b>	<b>Session: SEISMIC PERFORMANCE OF BRIDGES</b>
11:00 - 11:15		<b>Invited Lecture</b> Chiara Bedon SEISMIC PERFORMANCE AND FRAGILITY ASSESSMENT OF GLASS CURTAIN WALLS: METHODS AND INFLUENCING PARAMETERS	<b>Invited Lecture</b> Hrvoje Smoljanović SEISMIC ANALYSIS OF MASONRY STRUCTURES	48# <b>Laurent Hakaj</b> , Jelena Ristic, Toni Arangelovski, Danilo Ristic: EXPERIMENTAL TESTING OF CIRCULAR RC BRIDGE PIER MODELS SUPPORTING DEVELOPMENT OF REFINED NONLINEAR 3D MICRO-MODEL
11:15 - 11:30				65# <b>Miloš Čokić</b> , Radomir Folić: SEISMIC ASSESSMENT OF THE DAMAGE LIMIT STATES OF EXISTING HIGHWAY BRIDGES
11:30 - 11:45		Marketing: FIPMEC	57# <b>Nikolina Živaljić</b> , Ivan Balić, Hrvoje Smoljanović, Boris Trogrlić, Ante Munjiza: SEISMIC ANALYSIS OF DRY STONE MASONRY STRUCTURES WITHIN THE DIOCLETIAN'S PALACE IN SPLIT	91# <b>Antonio Shoklarovski</b> , Aleksandra Bogdanovic, Zoran Rakicevic, Filip Manojlovski, Angela Poposka: EXPERIMENTAL IN-SITU TESTING OF AN EXISTING BRIDGE
11:45 - 12:00		92# <b>Leart Taravari</b> , Koce Todorov: PERFORMANCE-BASED SEISMIC ASSESSMENT OF RC FRAME STRUCTURES USING SIMPLIFIED SDOF INCREMENTAL DYNAMIC ANALYSES	146# <b>Madalena Ponte</b> , Andrea Penna, Gabriele Guerrini, Rita Bento: SEISMIC VULNERABILITY ASSESSMENT OF COMPLEX HISTORICAL MASONRY AGGREGATES WITH INTERACTIONS BETWEEN STRUCTURAL UNITS	25# <b>Savvinos Aristeidou</b> , Gerard O'Reilly: COMBINING CONVENTIONAL AND NEXT-GENERATION INTENSITY MEASURES FOR RISK ASSESSMENT OF BRIDGE STRUCTURES WITH HAZARD-CONSISTENT GROUND MOTIONS
12:00 - 12:15		36# <b>Komaravolu Venkata Purneshwar</b> , Kaustubh Dasgupta, Nilanjan Samanta: EFFECTIVE STIFFNESS OF FLANGED REINFORCED CONCRETE STRUCTURAL WALLS: A NUMERICAL APPROACH	64# <b>Karl Deix</b> , Branko Rusnov: PREDICTION OF MASONRY STRENGTH AND EARTHQUAKE CHARACTERISTICS USING MACHINE-LEARNING ALGORITHMS FOR GRÜNDERZEIT BUILDINGS IN VIENNA	93# <b>Angela Poposka</b> , Aleksandra Bogdanovic, Antonio Shoklarovski, Filip Manojlovski, Zoran Rakicevic: EXPERIMENTAL ASSESSMENT OF EXISTING BRIDGE STRUCTURE
12:15 - 12:30		51# <b>Andela Čavčić</b> , Ivan Banović, Nikola Grgić, Alen Harapin: SEISMIC BEHAVIOR OF PREFABRICATED WALL PANELS	113# <b>Paulo Ščulac</b> , Josipa Mihaljević, Ivana Štimac Grandić, Davor Grandić: ASSESSING MECHANICAL PROPERTIES OF HISTORIC STONE MASONRY: CASE STUDY IN JURDANI (RIJEKA)	120# <b>Ana Mandić Ivanković</b> , Mladen Srbić, Gordana Hrelja Kovačević: NEW PROVISIONS FOR SEISMIC DESIGN OF BRIDGES
12:30 - 12:45		58# <b>Aleksandar Zhurovski</b> , Borjan Petreski, Igor Gjorgjiev: IMPROVED SEISMIC ASSESSMENT OF EXISTING RC FRAME STRUCTURES	5# <b>Davorin Penava</b> , Lars Abrahamczyk, Marin Valinčić, Ante Vrban: EFFECTIVENESS OF BUILT HERITAGE CONSTRUCTION IN RESISTING STRONG EARTHQUAKES: A REVIEW OF POST-1979 MONTENEGRO EARTHQUAKE RETROFITTING OF THE RECTOR'S PALACE IN DUBROVNIK	99# <b>Borjan Petreski</b> , Igor Gjorgjiev, Marija Vitanova, Ana Nanevska, Filip Manojlovski, Trajche Zafirov, Vlado Micov: REMOTE TESTING AND ASSESSMENT OF DIFFERENT TYPES OF BRIDGE STRUCTURES USING ADVANCED EVALUATION METHODS
12:45 - 13:00		151# <b>Krešimir Todorčić</b> , Mario Uros: SEISMIC ISOLATION OF THE EXISTING REINFORCED CONCRETE BUILDING	141# <b>Satwant Rihal</b> : PERFORMANCE ANALYSIS OF HISTORICAL CHURCHES AND MOSQUES DURING RECENT EARTHQUAKES – SOME PERSPECTIVES ON APPLICATION OF AI/ ML SYSTEMS	150# <b>Marija Kušter Marić</b> , Petra Milić, Anđelko Vlačić, Mladen Srbić, Ana Mandić Ivanković, Dominik Skokandić: IMPACT OF ENVIRONMENT AND CLIMATE CHANGE ON SEISMIC RESISTANCE OF CONCRETE BRIDGES
13:00 - 14:00		LUNCH		
	<b>PANEL DISCUSSION - RULES AND GUIDELINES FOR THE DESIGN OF SIMPLE MASONRY BUILDINGS IN SEISMICALLY ACTIVE AREAS</b>  14:00 – 14:10 <b>Mario Uroš</b> : INTRODUCTION TO SESSION 14:10 – 14:55 <b>C. Butenweg</b> : Seismic Design of Masonry Structures with the Second Generation of Eurocodes - Background and Application 14:55 – 15:15 <b>D. Grandić, K. Tarnik</b> : Work on the national annex for simple masonry buildings: Croatian experiences 15:15 – 16:00 Round Table, Discussion	<b>Session: SEISMIC LOSS AND RISK ANALYSIS</b>	<b>Session: ENGINEERING SEISMOLOGY</b>	<b>Session: REPAIR AND STRENGTHENING OF STRUCTURES</b>
14:00 - 14:15		<b>Invited Lecture</b> Tiago Miguel Ferreira SEISMIC RISK ASSESSMENT IN URBAN AREAS: INNOVATIVE APPROACHES TO SUPPORT LARGE-SCALE VULNERABILITY EVALUATIONS IN THE DIGITAL AGE	<b>Invited Lecture</b> Stefano Parolai EXAMPLES OF APPLICATION OF SEISMIC INTERFEROMETRY IN ENGINEERING SEISMOLOGY	Marketing: MAPEI
14:15 - 14:30				15# <b>Maziar Fahimi Farzam</b> , Salehy Shahram: OPTIMAL ESTIMATION OF LINEAR SHEAR-TYPE MODELS FOR BENCHMARK STEEL STRUCTURES IN DYNAMIC ANALYSIS
14:30 - 14:45		18# <b>Barbara Borzi</b> , Antonella di Meo, Marta Faravelli: SP-BELA: A STRUCTURAL SEISMIC VULNERABILITY ASSESSMENT METHODOLOGY BASED ON PUSH-OVER CURVES	62# <b>Marijan Herak</b> , Davorka Herak: PATTERNS OF EARTHQUAKE DAMAGE IN STON: A 146-YEAR COMPARISON	24# <b>Sergey Churilov</b> : NUMERICAL VALIDATION OF MASONRY WALL EXPERIMENTS USING THE APPLIED ELEMENT METHOD
14:45 - 15:00		30# <b>Davit Shahnazaryan</b> , Volkan Ozsarac, Gerard O'Reilly: BRIDGING THE GAP: A SOFTWARE TOOL FOR EFFICIENT GROUND MOTION SELECTION IN EARTHQUAKE ENGINEERING	159# <b>Atefe Darzi</b> , Benedikt Halldórsson, Mojtaba Moosapoor: INVESTIGATING TIME-DEPENDENT EARTHQUAKE CLUSTERING IN SHORT-TERM RISK ANALYSIS	73# <b>Goran Chapragoski</b> , Golubka Nechevska Cvetanovska: BIM APPLICATION IN SEISMIC STRENGTHENING OF REINFORCED CONCRETE BUILDING USING FRP MATERIALS
15:00 - 15:15		19# <b>Tomas Mejia</b> , Gerard O'Reilly: ON THE IMPACTS OF STRUCTURE-TO-STRUCTURE DAMAGE CORRELATION FOR REGIONAL SEISMIC RISK ASSESSMENT	161# <b>Benedikt Halldórsson</b> , Atefe Darzi, Farnaz Bayat, Hamed Davari, Milad Kowsari: TOWARDS A HYBRID SEISMIC HAZARD MODEL FOR ICELAND	100# <b>Matthias Roik</b> , Caroline Piesker: TESTS ON SPECIAL ANCHORS FOR MASONRY INFILLS WITH SPECIAL OPPORTUNITY FOR SEISMIC RETROFITTING

15:15- 15:30		31# <b>Davit Shahnazaryan</b> , Gerard O'Reilly: ENHANCING FUNCTIONAL RECOVERY ESTIMATIONS THROUGH STORY LOSS FUNCTIONS	158# <b>Farnaz Bayat</b> , Benedikt Halldórsson, Milad Kowsari: PARAMETRIZATION OF SYNTHETIC NEAR-FAULT SEISMIC WAVEFIELDS FOR THE SOUTHWEST ICELAND TRANSFORM ZONE	147# <b>Festim Ademi</b> , Elena Dumova-Jovanoska, Sergey Churilov, Enis Jakupi: SEISMIC RETROFIT OF MASONRY WALLS USING REPOINTING WITH TRADITIONAL MORTAR AND POLYPROPYLENE STRIPS - TEST RESULTS
15:30- 15:45		164# <b>Neja Fazarinc</b> , Anže Babič, Matjaž Dolšek: APPLICATION OF PARAMETRIC PUSHOVER CURVE MODEL FOR SEISMIC LOSS ESTIMATION OF BUILDING STOCK	136# <b>Zabedin Nezir</b> , Ljubcho Jovanov, Radmila Salic Makreska, Katerina Drogreshka, Laurentiu Danciu, Jasmina Najdovska, Daniel Tomic: IMPROVEMENT AND UPDATES OF THE NATIONAL DATABASES FOR SEISMOGENIC SOURCE MODELING IN THE CONTEXT OF REVISING THE NATIONAL HAZARD MODEL FOR NORTH MACEDONIA	165# <b>Ante Mlinar</b> , Ante Kelava, Ante Borovina, <b>Ante Buzov</b> : STRUCTURAL RECONSTRUCTION OF THE BELFRY, MONASTERY AND CHURCH OF ST. FRANCIS ON THE KAPTOL IN ZAGREB
15:45- 16:00		127# <b>Bojana Petrović</b> , Chiara Scaini, Danijel Schortlemmer: FROM GLOBAL TO LOCAL EXPOSURE DATASETS: ACCOUNTING FOR THE DYNAMIC PROPERTIES OF BUILDINGS IN SEISMIC EXPOSURE AND DAMAGE ASSESSMENT	160# <b>Hamed Davari</b> , Atefe Darzi, Benedikt Halldórsson, Birgir Hrafnkelsson, Milad Kowsari, Sahar Rahpeyma: DEVELOPING EARTHQUAKE GROUND MOTION MODELS FOR ICELAND USING BAYESIAN HIERARCHICAL MODELING	85# <b>Simon Petrovič</b> , Petra Prašnikar, Vojko Kilar: SEISMIC ASSESSMENT AND COST-BENEFIT ANALYSIS OF RETROFITTING MEASURES FOR POST-WAR MULTI-RESIDENTIAL MASONRY BUILDINGS IN LJUBLJANA
16:00- 16:15	Coffee break			
16:15- 16:30	Coffee break			
	<b>Session: SEISMIC PERFORMANCE OF STRUCTURES</b>	<b>Session: PREPAREDNESS AND EMERGENCY MANAGEMENT</b>	<b>Session: ENGINEERING SEISMOLOGY &amp; GEOTECHNICAL EARTHQUAKE ENGINEERING</b>	<b>Session: REPAIR AND STRENGTHENING OF STRUCTURES</b>
16:30- 16:45	128# <b>Tanja Kalman Šipoš</b> , Adriana Brandis: INFLUENCE OF GROUND MOTION PARAMETERS ON SEISMIC RESPONSE	129# Anže Babič, Can Baran Aktaş, Christina Rechberger, <b>Jelena Pejović</b> , Marco Gaetani d'Aragona, Maria Polese, Marta Faravelli, Matjaž Dolšek, Mehmet Firat Aydın, Neja Fazarinc, Nina Serdar, Paolo Ricci, René Kastner, Riza Secer Orkun Keskin, Serena Cattari, Valerio Poggi, Özkan Kale: ENHANCING URBAN DISASTER RISK MANAGEMENT: A TRANSNATIONAL ANALYSIS OF SEISMIC RISK ASSESSMENT FRAMEWORKS IN EUROPE	162# <b>Milad Kowsari</b> , Benedikt Halldórsson: PHYSICS-BASED SITE-SPECIFIC PSHA FOR SEVERAL URBAN CENTERS IN SOUTHWEST ICELAND	8# <b>Artur Roshi</b> , Golubka Nechevska-Cvetanovska, Jordan Bojadjev: COMPARISON OF RESULTS OBTAINED FROM ANALYTICAL AND EXPERIMENTAL INVESTIGATIONS OF RC BUILDING COLUMNS USING CFRP
16:45- 17:00	145# <b>Ivana Drobňjak</b> , Marina Rakočević: ANALYSIS OF REINFORCED CONCRETE BEAM-COLUMN JOINT IN ANSYS SOFTWARE	68# <b>Igor Gjorgjiev</b> , Marija Vitanova, Marta Stojnaoska: DEPLOYING OF SEISMIC ALERT WARNING SYSTEMS IN INDUSTRIAL FACILITY	126# <b>Snezana Stamatovska</b> : LOCAL EARTHQUAKES - GROUND MOTION MODELS FOR EPICENTRAL ZONE	163# <b>Tomislav Brozović</b> , Tomislav Kisicek: DYNAMIC ASSESSMENT OF RC BEAMS FLEXURALLY STRENGTHENED WITH CFRP STRIPS
17:00 - 17:15	87# <b>Riste Volchev</b> , Nikola Postolov, Koce Todorov, Ljupcho Lazarov: THE INFLUENCE OF STRUCTURAL ECCENTRICITY ON THE SEISMIC BEHAVIOR OF TORSIONALLY SENSITIVE STRUCTURES	139# <b>Mislav Stepinac</b> , Lucijano Bajič, Milan Domazet: THE USE OF UAVS IN ASSESSING SEISMIC VULNERABILITY OF EXISTING URM BUILDINGS	3# <b>Rashid Shams</b> , Chukwuebuka Nweke, Chenhao Wu, Henry Burton: A CAUSAL LENS PERSPECTIVE ON BASIN EFFECTS	41# <b>Stefano Barone</b> : SEISMIC RETROFIT OF 'PLINIO IL GIOVANE' SCHOOL BUILDING: MAJOR APPLICATION OF BASE ISOLATION USING HIGH DAMPING RUBBER BEARINGS
17:15- 17:30	26# <b>Mohammad Ghanooni Bagha</b> , Zeinolabedi Mortezaali, Peyman Shadman Heidari: EVALUATION THE SEISMIC PERFORMANCE OF THE HONEYCOMB YIELDING DAMPER(HYD)	142# <b>Radmila Salic Makreska</b> , Igor Gjorgjiev, Julijana Bojadjeva, Vlatko Sesov, Roberta Apostolska, Goran Chapragoski: EMERGE: RAPID MULTI-RISK NEEDS EVALUATION AND PLANNING PLATFORM	42# <b>Davor Stanko</b> , Dragana Dogančić, Sanja Kovač, Jasmin Jug, Stjepan Strelec, Vesna Poslončec-Petrić, Marijan Kovačić, Francesco Panzera, Olga-Joan Ktenidou: SEISMIC GROUND MOTION AMPLIFICATION INDUCED BY TOPOGRAPHIC IRREGULARITY IN NORTHERN CROATIA – PRELIMINARY RESULTS	152# <b>Karlo Grgurić</b> , Mario Uros: SEISMIC ASSESSMENT OF THE PRECODE HIGH RISE BUILDING FRAME USING THE PUSHOVER ANALYSIS
17:30- 17:45	Transfer to the Faculty of Civil Engineering, Architecture and Geodesy, University of Split			
17:45- 18:00	Arrival and Registration at the Faculty of Civil Engineering, Architecture and Geodesy, University of Split			
18:00 - 18:15	<b>PhD special session</b>			
18:15- 18:30	22# <b>Jose Poveda</b> , Gerard O'Reilly: INFLUENCE OF GROUND MOTION RECORD SELECTION ON HIGHER MODES: A COMPARISON OF UHS AND CS APPROACHES	<b>Student Competition at the Faculty (shaking table)</b>		
18:30- 18:45	29# <b>Liljana Bozinovska Mijalkova</b> , Aleksandra Bogdanovic, Bartolomeo Panto, Enrico Tubaldi, Marko Marinković: ANALYTICAL APPROACH TO SEISMIC BEHAVIOUR ASSESMENT OF RC FRAME STRUCTURES WITH RUBBER JOINTED MASONRY INFILL			
18:45- 19:00	38# <b>George Papagiannopoulos</b> , Menelaos Papamichelakis: EFFECT OF BASE COLUMN ROTATIONAL STIFFNESS ON THE SEISMIC RESPONSE OF STEEL FRAMED BUILDINGS			
19:00 - 19:15	46# <b>Maja Mrkonjic</b> , Josip Atalić: RESPONSE OF THE BUILDING IN AGGREGATES ACCORDING TO THE INTERCONNECTED DIFFERENT PARAMETERS			
19:15- 19:30	49# <b>Mario Žigo</b> , Marina Nikolić, Marija Smilović-Zulim, Nikola Grgić: NATURAL COMPOSITES IN CONSTRUCTION: OVERVIEW OF THE DEVELOPMENT, APPLICATION AND CHALLENGES OF NATURAL FIBER REINFORCED CEMENTITIOUS MATRIX (NFRCM)			
19:30- 19:45	86# <b>Marina Poposka</b> , Davor Stanko, Radmila Salic Makreska, Dragi Dijčinovski, Marta Stojnaoska: NEAR-DISTANCE SPECTRAL PARAMETER KAPPA CALCULATIONS FOR STATIONS INSTALLED IN N. MACEDONIA			
19:45- 20:00				
20:00- 00:00	Football Match Viewing at the Faculty			

FRIDAY 21/3/2025				
Ballroom				
Keynote Lecture Michael N. Fardis				
COMPARISON OF TWO GENERATIONS OF EUROCODES FOR EARTHQUAKE-RESISTANT CONCRETE BUILDINGS THROUGH SYSTEMATIC APPLICATIONS				
Keynote Lecture Gian Michele Calvi				
SEISMIC ISOLATION IN LOSS-BASED DESIGN				
Coffee break				
Ballroom	Oleandar	Ruzmarin	Palma	Agava
<b>SPECIAL SESSION: REPAIR AND RETROFIT OF STRUCTURES</b>	<b>Session: HISTORICAL STRUCTURES</b>	<b>Session: SEISMIC PERFORMANCE OF STRUCTURES</b>	<b>Session: GEOTECHNICAL EARTHQUAKE ENGINEERING</b>	<b>Session: SEISMIC LOSS AND RISK ANALYSIS</b>
11:00 – 11:15 11:00 – 11:05 INTRODUCTION TO SPECIAL SESSION by <b>A. Elnashai</b> 11:05 – 11:35 OVERVIEW OF THE MORNING SESSION – GUIDELINES AND REGULATIONS by M. Calvi	70# <b>Jasna Grujoska Kuneska</b> , Veronika Shendova: INTEGRATED NON-DESTRUCTIVE APPROACH FOR DIAGNOSIS OF HISTORIC MONUMENTS	144# <b>Andrea Brunelli</b> , Silvia Pinasco, Serena Cattari, Sergio Lagomarsino: APPLICATION OF THE NEW EUROCODE 8 TO THE SEISMIC ASSESSMENT OF AN EXISTING BUILDING IN ZAGREB	<b>Invited Lecture</b> <b>Ioannis Anastasopoulos</b> <b>EXPLOITING NONLINEAR SOIL-FOUNDATION RESPONSE IN DEFENCE OF THE SUPERSTRUCTURE</b>	106# <b>Danijel Schorlemmer</b> , Chengzhi Rao, Juan Camilo Gomez Zapata, Lars Lingner, Laurens Oostwegel, Pablo De la Mora Lobaton, Tara Evaz Zadeh: EVERY BUILDING ON EARTH
11:15 – 11:30 11:35 – 11:55 <b>V. Sendova</b> : EARTHQUAKE PROTECTION OF HERITAGE STRUCTURES: STATUS OF REGULATIONS AND PRACTICE IN NORTH MACEDONIA	55# <b>Naser Kabashi, Teuta Imeri</b> , Alush Shala, Enes Krasniqi, Ylli Murati: ASSESSMENT, EVALUATIONS AND RETROFITTING APPLICATIONS METHODS FOR MASONRY OLD STONE STRUCTURE	133# <b>Meta Krzan</b> : PUSHOVER ANALYSIS OF TIMBER BUILDINGS WITH LIGHT FRAME PANELS FOR ENGINEERING PRACTICE: METHOD DESCRIPTION, DISCUSSION, AND HIGHLIGHTING RESEARCH GAPS		
11:30 – 11:45 11:55 – 12:15 <b>E. Vintzeleu</b> : BEHAVIOR AND DESIGN OF INTERFACES BETWEEN CONCRETES CAST AT DIFFERENT TIMES	107# <b>Mustafa Hrasnica</b> , Amina Karavelić-Hadžimejlić, Senad Medic, Jelena Medic: SEISMIC EVALUATION OF THE HIGH-RISE RESIDENTIAL BUILDING WITH STRUCTURAL WALLS FROM THE LATE 60'S	95# <b>Nemanja Krtnić</b> , Matija Gams, Marko Marinković: MODELLING THE SEISMIC RESPONSE OF A THREE STOREY CONFINED MASONRY BUILDING USING EQUIVALENT DIAGONAL STRUT MODELS	148# <b>Mario Bacic</b> , Lovorka Libric, Meho Saša Kovačević: LIQUEFACTION ASSESSMENT USING A SYNTHETIC CPT DERIVED FROM CORRELATION WITH SHEAR WAVE VELOCITY	40# <b>Elena Dumova-Jovanoska</b> , Kristina Milkova, Sergey Churilov, Simona Bogojevka: INTEGRATING SEISMIC RISK ASSESSMENT INTO SPATIAL PLANNING: CASE REPUBLIC OF NORTH MACEDONIA
11:45 – 12:00 12:15 – 12:35 <b>G. O'Reilly</b> : RECENT DEVELOPMENTS IN THE RISK-TARGETED REPAIR AND RETROFITTING OF EXISTING STRUCTURES	59# <b>Milica Petrović</b> , Svetlana Nikolić Brzev: SEISMIC FEATURES OF EXISTING PREFABRICATED SYSTEMS FOR MULTI-FAMILY HOUSING CONSTRUCTION IN SERBIA AND THE REGION: CASE STUDY OF NEW BELGRADE	28# <b>Babar Ilyas</b> , Dario Vecchio, Nuno Mendes, Paulo B. Lourenco: SHAKE TABLE TESTING OF U-SHAPED MASONRY STRUCTURES: OUT-OF-PLANE RESPONSE TO VARYING GROUND MOTION SIGNALS	16# <b>Jasmin Jug</b> , Stjepan Strelec, Kristijan Grabar, Dragana Dogančić, Anja Bek: LANDSLIDE TRIGGERING AS AN INDIRECT CONSEQUENCE OF AN EARTHQUAKE - CASE STUDY FROM NORTHERN CROATIA	53# <b>Kristina Milkova</b> , Marta Savor Novak, Marko Marinković, Elena Dumova-Jovanoska: A REVIEW OF EXISTING SEISMIC VULNERABILITY FUNCTIONS FOR BUILDINGS IN THE BALKAN REGION
12:00 – 12:15 12:35 – 12:55 <b>A. Benavent-Climent</b> : APPLICABILITY OF THE NEW METHODS OF THE SECOND-GENERATION OF EUROCODE 8 TO SEISMIC UPGRADING RC FRAMES USING HYBRID DAMPERS WITH RECENTERING CAPABILITY	121# <b>Camil Medanovic, Naida Ademovic</b> , Marijana Hadzima-Njarko: SEISMIC ASSESSMENT OF A HISTORIC AUSTRO-HUNGARIAN MASONRY BUILDING IN SARAJEVO'S BAŠČARŠIA	132# <b>Florim Grajčević, Valon Veseli</b> , Labeat Misini, Zijadin Guri, Ilir Canaj: ANALYTICAL INVESTIGATION OF MASONRY INFILL REINFORCED CONCRETE FRAMES UNDER AXIAL AND LATERAL LOADING	137# <b>Vedran Jagodnik, Davor Marušić, Ivana Bošnjak, Neira Mušić</b> : SAND AND SAND-KAOLINE MIXTURES CYCLIC PROPERTIES UNDER LOW CONFINING STRESS	60# <b>Nina Serdar</b> , Jelena Pejović: BUILDING EXPOSURE MODELLING FOR NATIONAL SEISMIC RISK ASSESSMENT IN MONTENEGRO
12:15 – 12:30 12:35 – 12:55 <b>L. di Sarno</b> : WRAP-UP, SUMMARY by <b>L. di Sarno</b>	4# <b>Antonela Moretić</b> , Karlo Ožić, Mislav Stepinac: A STATE-OF-THE-ART REVIEW: SEISMIC VULNERABILITY ASSESSMENT METHODS	96# <b>Marko Marinković</b> , Christoph Butenweg: IN-PLANE BEHAVIOUR OF RC FRAMES WITH TRADITIONAL AND DECOUPLED INFILLS: PARAMETRIC STUDY	78# <b>Dejan Ivanovski</b> , Jovana Ristova, Julijana Bojadjeva, Kemal Edip, Vlatko Sheshov, Toni Kitanovski: CANTILEVER RETAINING WALL ANALYSIS ACCORDING TO EUROCODE 7 AND 8 IN DRAINED AND UNDRAINED CONDITIONS	108# <b>Daniel Tomic</b> , Radmila Salic Makreska, Marija Vitanova, Zabeđin Nezir, Noah Martin: IMPROVEMENT OF THE EXPOSURE MODEL AND PRELIMINARY PHYSICAL RISK ANALYSIS: A PILOT CASE IN AERODROM-SKOPIJE MUNICIPALITY
12:30 – 12:45	71# <b>Jasna Grujoska Kuneska</b> , Veronika Shendova: ASSESSMENT OF THE PHYSICAL CONDITION OF BYZANTINE CHURCHES IN NORTH MACEDONIA	43# <b>Naser Kabashi, Enes Krasniqi, Florim Grajčević, Milot Muhaxheri, Ylli Murati, Valon Veseli</b> : SEISMIC VULNERABILITY ASSESSMENT OF 1960S REINFORCED CONCRETE FRAME BUILDINGS WITH INFILL MASONRY WALLS	94# <b>A S M Fahad Hossain</b> , Ali Saaidi, Mohammad Salsabili, Miroslav Nastev, Julijana Ruiz Suescun: EVALUATION OF THE FUNDAMENTAL SITE PERIOD INCLUDING THE NONLINEAR SOIL BEHAVIOR: A CASE STUDY OF THE SAGUENAY, EASTERN CANADA	17# <b>Željana Nikolić</b> , Elena Benvenuti, Luka Runjić, Nenad Mladineo, Marko Mladineo: RECENT ADVANCES IN SEISMIC VULNERABILITY ASSESSMENT OF CROATIAN COASTAL URBAN AREA
12:45 – 13:00	149# <b>Franka Meštrović</b> , Ivo Haladin, Katarina Vranešić, Krešimir Burnač, Zvonimir Šantek: ASSESSMENT OF TRAM-INDUCED VIBRATIONS ON EARTHQUAKE-DAMAGED BUILDINGS	45# <b>Maja Baniček</b> , Mahmoud Shaqfa, Josip Atalić, Sara Vaing: PREDICTING MODAL PARAMETERS OF DAMAGE STAGES AND RETROFIT METHODS OF A URM MASONRY BUILDING	140# <b>Saltanat Yesselbayeva</b> , Máté Urbán, Péter Görög: EFFECT OF SEISMIC LOAD ON THE STABILITY OF A DOLOMITE QUARRY IN HUNGARY	83# <b>Marin Grubišić</b> : SEISMIC RISK AND LOSS ASSESSMENT OF REINFORCED CONCRETE FRAME STRUCTURES STRENGTHENED BY THE ADDITION OF MASONRY INFILL WALLS
13:00 – 14:00	LUNCH			
<b>SPECIAL SESSION: REPAIR AND RETROFIT OF STRUCTURES</b>	<b>Session: PREPAREDNESS AND EMERGENCY MANAGEMENT &amp; POST-EARTHQUAKE RECONSTRUCTION PROCESS</b>	<b>Session: SEISMIC PERFORMANCE OF STRUCTURES</b>	<b>Session: GEOTECHNICAL EARTHQUAKE ENGINEERING &amp; SEISMIC PERFORMANCE OF STRUCTURES</b>	<b>Session: SEISMIC LOSS AND RISK ANALYSIS</b>
14:00 – 14:15 14:00 – 14:05 INTRODUCTION TO SESSION by <b>A. Elnashai</b> 14:05 – 14:35 OVERVIEW OF THE AFTERNOON SESSION by <b>M. Fardis</b> 14:35 – 14:55 <b>S. Pantazopoulos</b> : ASSESSING AND MITIGATING THE EFFECTS OF REINFORCEMENT CORROSION IN BRIDGE INFRASTRUCTURE WITH NOVEL CEMENTITIOUS MATERIALS: THE OPPORTUNITIES PROVIDED BY ULTRA-HIGH PERFORMANCE CONCRETE	72# <b>Marija Vitanova</b> , Roberta Apostolska, Vlatko Sheshov, Ana Nanevska, Dejan Ivanovski, Filip Manojlović, Goran Jekić, Elena Delova: BUILDING RESILIENT COMMUNITIES: ADVANCING STEM EDUCATION AND EARTHQUAKE ENGINEERING RESEARCH	122# <b>Goran Simonovic</b> , Mustafa Hrasnica, Senad Medic: INTERACTION BETWEEN MASONRY WALLS AND CONSTRUCTION	Marketing: RADNIK	89# <b>Peshawa Luqman Hasan</b> , Baban Bapir, Brva Hamah Saeed Hamah Ali, Serwan Rafiq, Lars Abrahamczyk: VULNERABILITY ASSESSMENT AND SEISMIC RISK ANALYSIS OF BUILDINGS IN IRAQ: INSIGHTS FROM BUILDING SURVEYS AND DAMAGE SCENARIOS
14:15 – 14:30 14:55 – 15:15 <b>R. Landolfo</b> : SEISMIC STRENGTHENING OF EXISTING BUILDINGS WITH STEEL EXOSKELETONS: DESIGN METHODOLOGY AND APPLICATIONS	131# <b>Šporesim Ibraimi</b> , Koce Todorov, Miroslav Nastev, Stanislav Milovanovic: BUILDING CLASSIFICATION MODEL FOR SEISMIC RISK ASSESSMENT OF GOSTIVAR, NORTH MACEDONIA	135# <b>Kenan Omerović</b> , Mario Uros, Senad Medic: ENGINEERING ANALYSIS OF A TYPICAL PRE CODE URM BUILDING IN ZAGREB	123# <b>Irena Gjorgjeska</b> , Vlatko Sheshov, Julijana Bojadjeva, Kemal Edip: THE ROLE OF SEISMIC GEOPHYSICAL METHODS IN NEAR-SURFACE CHARACTERIZATION	69# <b>Lisa Jusufi</b> , Roberta Apostolska: SCENARIO-BASED SEISMIC RISK ASSESSMENT OF SCHOOL BUILDINGS IN THE SKOPIJE AREA, NORTH MACEDONIA
14:30 – 14:45 15:15 – 15:35 <b>S. Bouasis</b> : LARGE SCALE EXPERIMENTAL VERIFICATION OF SEISMIC RETROFITTING OF SUBSTANDARD RC STRUCTURES	98# <b>Izet Mehmetaj</b> , Erjon Çobani: INCREASING STRUCTURAL RESILIENCE: A CASE STUDY OF HOSPITAL RETROFITTING IN ALBANIA	166# <b>Robert Buzjak</b> , Mario Uros: INFLUENCE OF CONNECTING ELEMENTS IN HORIZONTAL LOAD-BEARING SYSTEM OF A MASS TIMBER OFFICE BUILDING	27# <b>Kemal Edip</b> , Davor Stanko, Julijana Bojadjeva, Radmila Šalic-Makreska, Vlatko Sheshov: EFFECTS OF GROUND MOTION INTENSITY IN ASSESSMENT OF SOIL SLOPES IN EARTHQUAKE DAM	75# <b>Aleksandar Zlateski</b> , Elena Delova, Veronika Shendova: SEISMIC VULNERABILITY ASSESSMENT OF PART OF HISTORIC CENTER OF SKOPIJE
14:45 – 15:00 15:35 – 15:45 WRAP-UP, SUMMARY by four Organizers	104# <b>Andelko Vlašić</b> , Marta Savor Novak, Ana Mandić Ivanković, Gordana Hrelja Kovačević, Mladen Srbić, Marija Kušter Marić, Dominik Skokandić, Jelena Bleiziffer: FIELD APPLICATION FOR ASSESSING THE DAMAGE AND USABILITY OF BRIDGES AFTER AN EARTHQUAKE	105# <b>Ivan Lukačević, Emanuel Krupa-Jurić, Ivan Čurković, Marko Barišić</b> : BEHAVIOUR OF DUAL STEEL FRAMES WITH INNOVATIVE DOUBLE SKIN COLD-FORMED STEEL CONCRETE COMPOSITE SHEAR WALLS	125# <b>Sanda Koboevic</b> , Bardia Ramin Afshar: THE EFFECTS OF SOIL-STRUCTURE INTERACTION ON THE SEISMIC DESIGN OF SHALLOW FOUNDATIONS FOR ECCENTRICALLY BRACED STEEL FRAMES	12# <b>Burbeq Shatri</b> , Golubka Nechevska-Cvetanovska: RAPID VISUAL SCREENING METHOD FOR RC BUILDING STRUCTURES
15:00 – 15:15	101# <b>Andelina Švirčić Gotovac, Jelena Zlatar Gamberozić</b> , Antun Dulbić: POST-EARTHQUAKE RECONSTRUCTION IN THE ZAGREB SETTLEMENTS MARKUŠEVAC AND ČUČERJE	119# <b>Trajče Zafirov</b> , Viktor Hristovski: COMPARATIVE NUMERICAL INVESTIGATION OF TIMBER ADDED FLOORS ON EXISTING RC STRUCTURES	79# <b>Toni Kitanovski</b> , Dejan Ivanovski, Julijana Bojadjeva, Kemal Edip, Vlatko Sheshov: LABORATORY TESTING ON SMALL STRAIN MODULES OF NATURAL SANDY DEPOSITS	143# <b>Daniel Tomic, Jovan Trajčevski</b> , Radmila Salic Makreska, Zoran Milutinović: DEVELOPMENT OF K QUOTIENT METHODOLOGY FOR INTER-CODE LATERAL FORCE COMPARISON
15:15 – 15:30	54# <b>Vesna Šipka</b> , Mirjana Landika: EARTHQUAKE RISK PERCEPTION IN BANJA LUKA: IMPLICATIONS FOR SEISMIC RISK MANAGEMENT	7# <b>Vasco Bernardo</b> , Paulo Candeias, António A. Correia: CHALLENGES AND CONSIDERATIONS FOR MODULAR CONSTRUCTION SYSTEMS IN SEISMIC PRONE REGIONS: A STATE-OF-THE-ART REVIEW	63# <b>Guxim Rudhani</b> , Josif Josifovski: THERMO-MECHANICAL BEHAVIOR AND STRUCTURAL DESIGN OF GEOTHERMALLY ACTIVE PILES	10# <b>Elena Delova</b> , Aleksandar Zlateski, Marin Grubišić, Veronika Shendova, Zivko Bozinovski: SEISMIC PERFORMANCE EVALUATION OF EXISTING REINFORCED CONCRETE BUILDINGS IN SKOPIJE
15:30 – 15:45	118# <b>Marko Šimić</b> , Dražen Brkić, Marija Kušter Marić, Anđela Ivanović: APPLICATION OF THE BAILEY BRIDGE IN POST-EARTHQUAKE INTERVENTIONS	114# <b>Paulo Ščulac</b> , Kristina Galjanić, Davor Grandić, Josipa Mihaljević, Željko Smolčić: TIES IN UNREINFORCED MASONRY STRUCTURES: CASE STUDY IN KRK	39# <b>Nikola Petrov</b> , Julijana Bojadjeva, Jordan Bojadjev: INFLUENCE OF KINEMATIC SOIL – STRUCTURE INTERACTION ON THE SEISMIC BEHAVIOUR OF REINFORCED – CONCRETE FRAME BUILDINGS	167# <b>Zvonko Sigmund</b> , Massimo Migliorini, Karlo Jandrić, Elios De Maio, Marina Nadalin: EDUCATION OF EXPERTS FOR DAMAGE ASSESSMENT OF BUILDINGS IMMEDIATELY AFTER AN EARTHQUAKE USING XR – PROJECT PROGRESS
15:45 – 16:00		82# <b>Marin Grubišić</b> , Benjamin Pervan: FINITE ELEMENT RESPONSE SENSITIVITY ANALYSIS OF STEEL SPECIAL CONCENTRICALLY BRACED FRAMES USING THE DIRECT DIFFERENTIATION METHOD		
16:00 – 16:15	CLOSING CEREMONY			
16:15 – 16:30	Presentation on the Marjan Hotel Construction Site			
16:30 – 16:45	TECHNICAL VISIT: Marjan Hotel			
16:45 – 17:00	Arrival at the Marjan Hotel Construction Site			
17:00 – 17:15	Technical Visit: Marjan Hotel			
17:15 – 17:30				
17:30 – 17:45				
17:45 – 18:00				

<b>SATURDAY 22/3/2025</b>	
08:30 - 09:00	08:30 - 10:20 Ferry from Split to Hvar
09:00 - 09:15	
09:15- 09:30	
09:30- 09:45	
09:45- 10:00	
10:00 - 10:15	
10:15- 10:30	
10:30- 10:45	Arrival in Stari Grad Port and Bus Transport to Hvar
10:45- 11:00	Technical Visit: City Fortress/ Fortica and Hvar Arsenal
11:00 - 11:15	
11:15- 11:30	
11:30- 11:45	
11:45- 12:00	
12:00 - 12:15	
12:15- 12:30	
12:30- 12:45	
12:45- 13:00	
13:00- 14:00	
14:00 - 14:15	
14:15- 14:30	
14:30- 14:45	
14:45- 15:00	
15:00 - 15:15	
15:15- 15:30	
15:30- 15:45	
15:45- 16:00	
16:00- 16:15	
16:15- 16:30	
16:30- 16:45	Return to Stari Grad Port and Ferry to Split
16:45- 17:00	17:30 - 19:20 Ferry from Hvar to Split
17:00 - 17:15	
17:15- 17:30	
17:30- 17:45	
17:45- 18:00	
18:00 - 18:15	
18:15- 18:30	
18:30- 18:45	
18:45- 19:00	
19:00 - 19:15	
19:15- 19:30	